



## SALOON BONNET STIFFENER BRACKETS | Instructions version 1.0



Thank you for your purchase. If you've bought these stiffening brackets it is likely that you are concerned with the strength and quality of your current bonnet. In a bid to drive down costs, the gauge of the steel used to build the mini was reduced in thickness. Unfortunately this had some unwanted side effects. The single skin of the saloon bonnet on later models can be extremely prone to bending and deformation even without fitting our vertical lift hinges. The area most prone to this is directly in front of the rear stiffened corners.

Our stiffener kit has been designed to bring strength back to that area without the need for drilling through paintwork or welding panels. Instead of mechanically fastening the stiffener kit on (which you are welcome to do if you so wish) we opted to use VHB™ tape from 3M™. VHB™ tape or Very High Bond tape has been used for 25 years in industries worldwide to permanently bond and seal many substrates for increased productivity, high strength, long term durability, and improved appearance.

We hope these instructions are clear but if you should have any questions at all, please STOP and ask first before proceeding. The tape is permanent so you need to have completed all steps before applying the brackets.

### \*\* ENCLOSED YOU WILL FIND \*\*

2x STIFFENING BRACKETS (B)

2x BRACES (D)

1x IPA CLEANING  
WIPE SACHET (E)

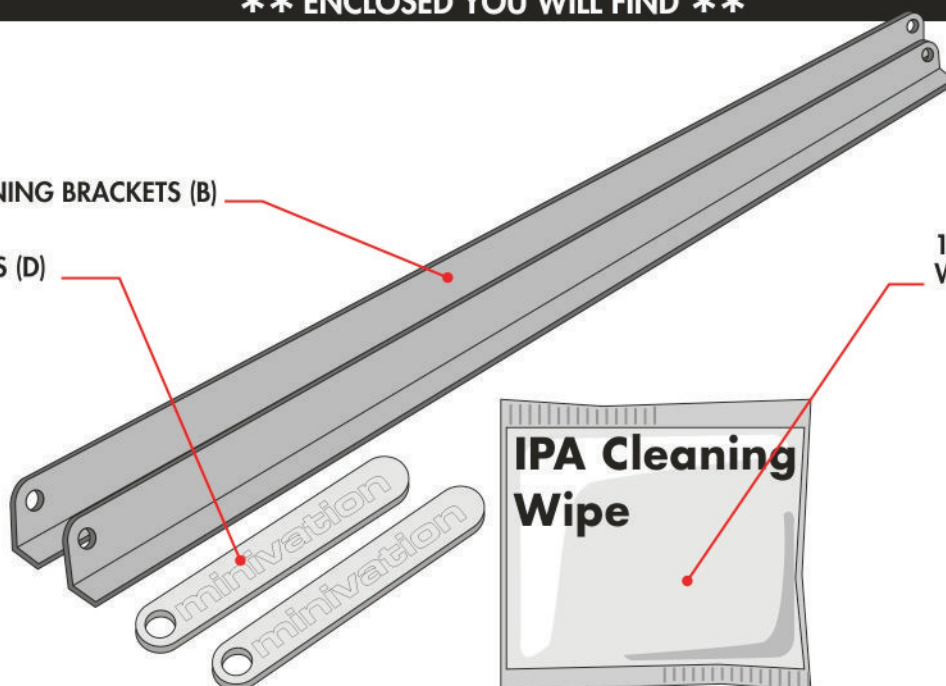

### \*\* YOU MAY NEED \*\*

A Soft Jawed pliers



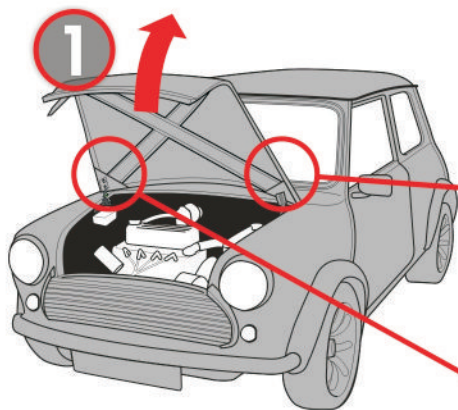

**\*\* VISUAL INSPECTION \*\***

(2,3) FIRSTLY INSPECT THE INNER AND OUTER EDGES OF BOTH SIDES OF YOUR BONNET.

YOU ARE LOOKING FOR CREASES, CRACKS, WARPING OR RUST.

**NOTE**

THIS KIT IS NOT A SOLUTION FOR A CRACKED OR RUSTY BONNET - THAT SHOULD BE FIXED BY A SUITABLE PROFESSIONAL FIRST.

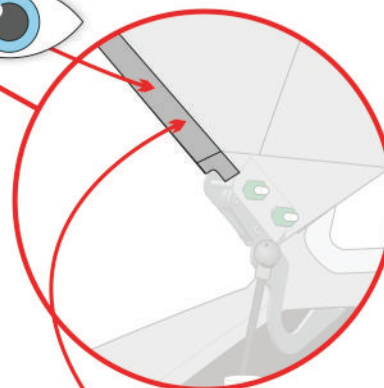
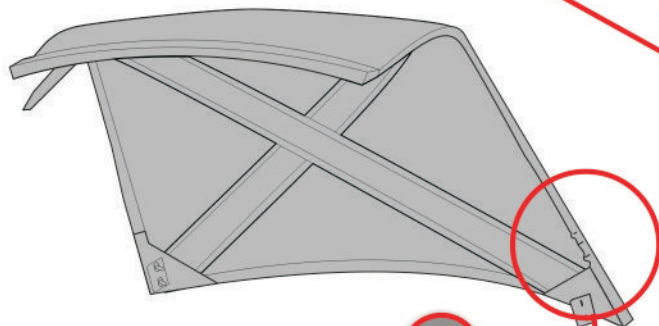

(4) WARPING OR CREASES LIKE THESE WILL NEED TO BE FLATTENED FIRST USING SOFT JAWED PLIERS OR BY SQUEEZING THE EDGES BETWEEN TWO PIECES OF WOOD.

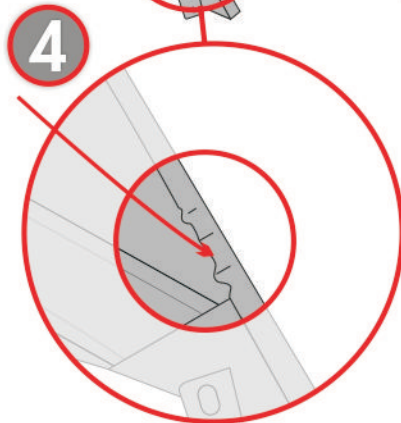

(5) NOW THE EDGES ARE NICE AND SMOOTH, YOU NEED TO CLEAN THE INSIDE EDGES OF THE BONNET THOROUGHLY TO REMOVE GREASE AND OILY RESIDUES.

(6) THEN, ONCE YOU ARE SURE THE SURFACES ARE TOTALLY CLEAN, OPEN THE IPA CLEANING WIPE. AND GO OVER THE AREA ONCE MORE.



E

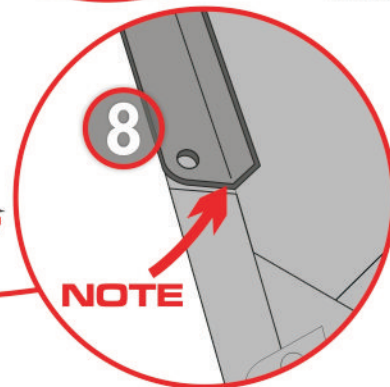
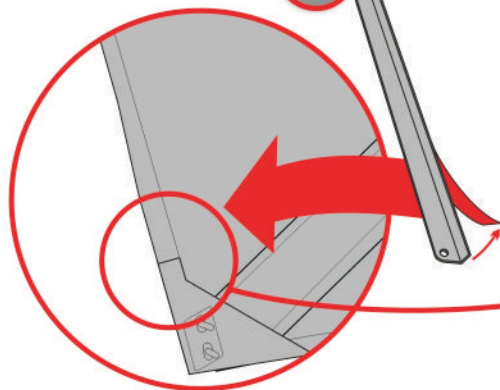

**NOTE**

(7) PEEL OFF THE BACKING THEN YOU NEED TO PUSH THE STIFFENER RIGHT INTO THE CORNER OF THE BONNET AND BUTT IT UP TO THE CORNER STIFFENER SO (8) THERE IS NO GAP AND THE STIFFENER DOES NOT PROTRUDE OVER THE EDGE.

(9) FINALLY CLEAN THE STIFFENER AND CORNER BRACKET WITH THE IPA WIPE BEFORE PEELING THE BACKING OF THE BRACE AND ATTACHING IT ACROSS THE JOIN.

(10) APPLY EVEN PRESSURE ALL ALONG THE STIFFENER AND BRACE FOR SEVERAL MINUTES.

NOW REPEAT ON THE OTHER SIDE

